

VQ33EH

Miniature Camera



VQ33EH-W

IP 67 Weatherproof

VQ33EH-VFA

Indoor

2.8-12mm DC Iris

VQ33EH-B

Indoor

Board lens

VQ33EH-PP

Indoor

Full Cone Pinhole

Key Features of Effio-E

- 1/3" Sony 960H Ex-view HAD CCD
- 650TVL(D)/ 700TVL(N)
- New Color Signal Processing for High Color Reproduction
- 2D DNR(Digital Noise Reduction)
- ATR(Adaptive Tone-Curve Reproduction)

Key Features of VQ33EH

- Digital Day & Night
- 12VDC

Dimension

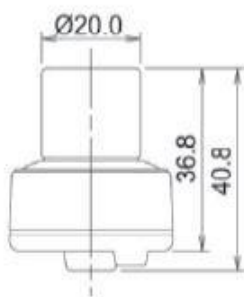

VQ33EH-W

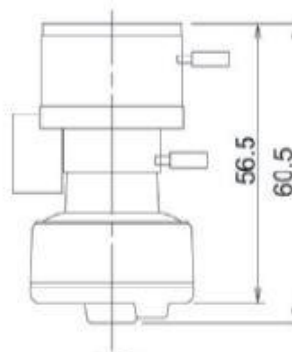

VQ33EH-VFA

Specification

MODEL	VQ33EH
Image sensor	1/3" Sony 960H Ex-view HAD CCD
Effective Pixels	NTSC : 768(H) x 494(V), PAL : 752(H) x 582(V)
H. Resolution	650TV Lines(Color)/ 700TV Lines(B/W)
Synchronizing system	Internal
Scanning system	NTSC : 525 Lines PAL : 625 Lines 2:1 Interlaced
Video output	1.0Vp-p Composite 75 Ohms
S/N ratio	More than 52dB (AGC Off)
Min. Illumination	0.1Lux(Color)/ 0.01Lux(B/W)
Shutter Speed	NTSC:1/60~1/100,000 sec. PAL:1/50~1/100,000 sec.
Gamma Correction	Standard $\gamma = 0.45$
White Balance	1,800°K ~ 11,000°K Auto
Gain Control	Standard : -6dB ~ 44.8dB Auto
Smear Effect	0.005%
Power source	12VDC
Operating current	100mA
Lens	VQ33EH-W : 2.9mm/ 3.6mm/ 4.3mm/ 6mm/ 8mm/ 12mm/ 16mm VQ33EH-VFA: 2.8-12mm/ 5-50mm Varifocal DC Auto Iris VQ33EH-B: 2.45mm/ 2.9mm/ 3.6mm/ 4.3mm/ 6mm/ 8mm/ 12mm/ 16mm VQ33EH-PP : 2.8mm/ 3.7mm/ 5.0mm Full Cone Pinhole
MTBF	80,000 hours
Iris Control	Electronics, VQ33EH-VFA : Auto
Operating temp./Humidity	-10°C ~ 50°C (Humidity : 0% RH ~ 90% RH)
IP Rating	VQ33EH-W : 67
Measurement (mm)	Refer to dimensions
Weight (Approx. g)	150